

# DM 200-D Click Wrench (Adjustable)

Rev. 1.0

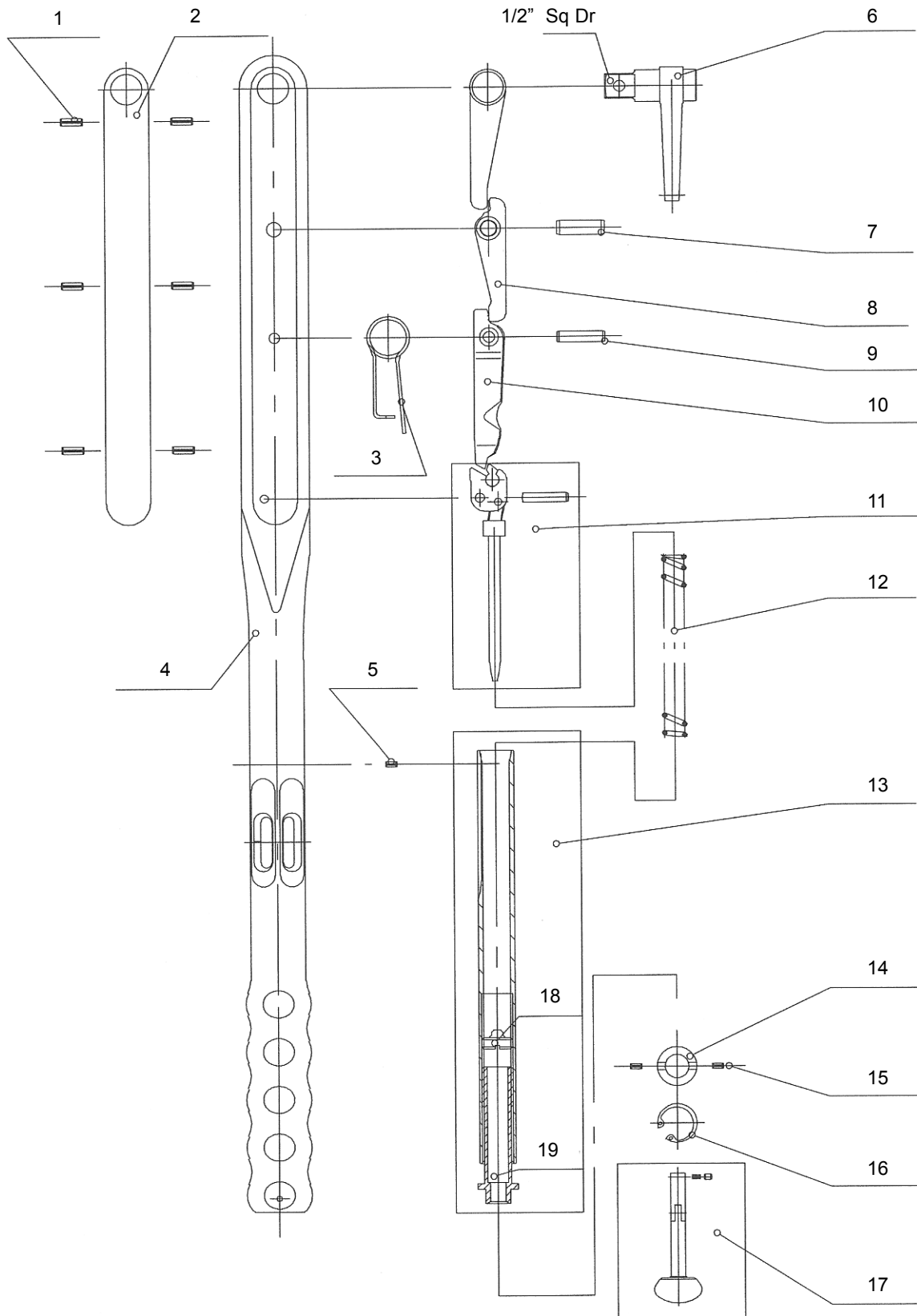

## DM 200-D Click Wrench (Adjustable)

Ref #	Part #	Quantity	Description
1	28-1180223	6	Dowel Pin ISO 8752 4x12
2	28-1183435	1	Lid DREMOMETER BC
3	28-1184016	1	Wing spring A-E
4	28-1199404	1	Body DREMOMETER BC fert.
5	28-1180215	1	Elastic pin 3x6
6	28-1206443	1	Two Sided Lever 1/2" B-C compl.
7	28-1183125	1	Cylindric Pin DREMOMETER BC-CZ
8	28-1181718	1	Intermediary Lever DREMOMETER BC-CD
9	28-1183095	1	Cylindric pin DREMOMETER A-CD
10	28-1183427	1	Final Lever DREMOMETER A-E
11	28-1196707	1	Angle Lever DREMOMETER C komplett
12	28-1183451	1	Compression Spring DREMOMETER BC
13	28-1182196	1	Tube BC compl.
14	28-1189700	1	Thrust washer A-F
15	28-1180215	2	Elastic pin 3x6
16	28-1180258	1	Safety ring 22x1
17	28-1182382	1	Hexagon key DREMOMETER A-F (NEW) complete
18	28-1180177	1	8563-10 Adjusting screw
19	28-1180517	1	Spindle Screw DREMOMETER BC-C