

Loading Bench Operation Instructions

Rev 3.0 (5/12/2011)

For LB250F, LB750F & LB2000F

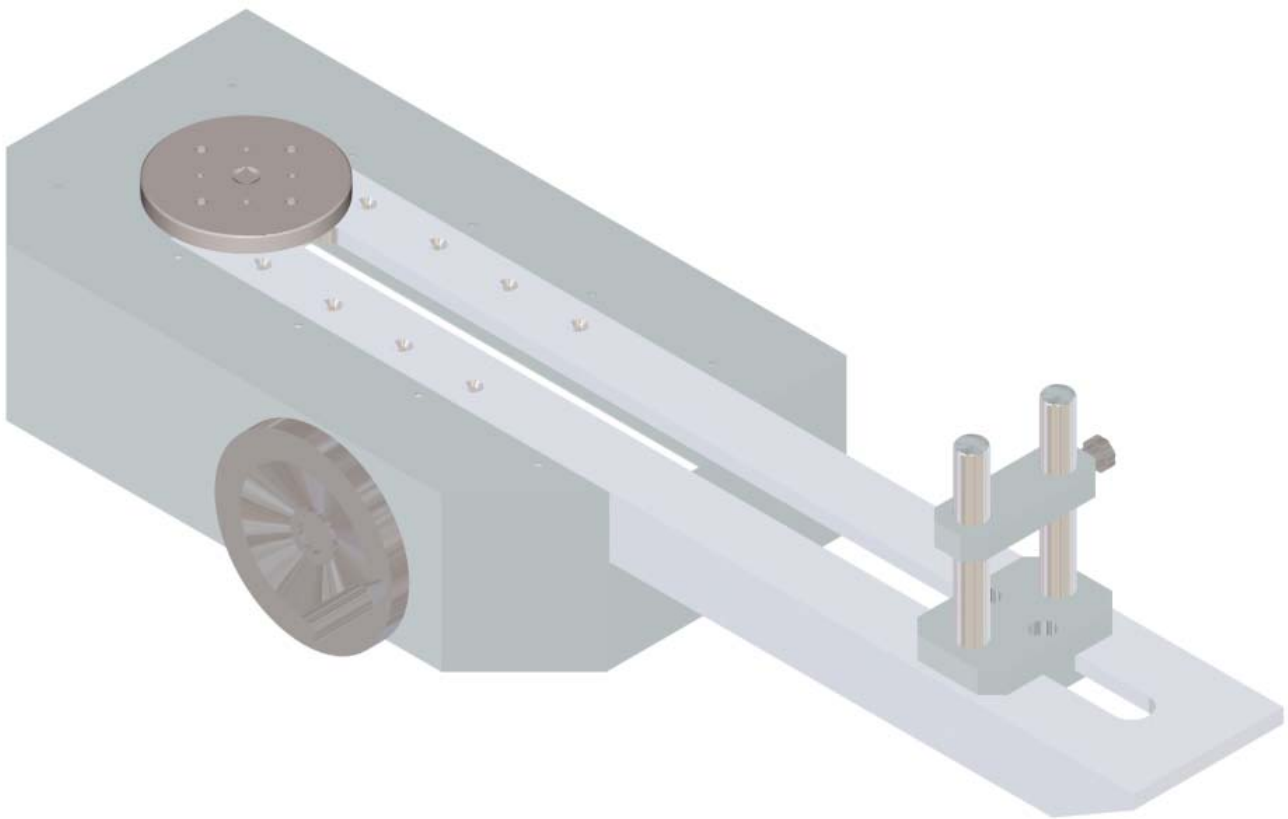

Specifications

Torque Range:

LB250F (Max Torque Capacity 250 lbf.ft)

LB750F (Max Torque Capacity 750 lbf.ft)

LB2000F (Max Torque Capacity 2000 lbf.ft)

Turn-Table

Base hole pattern for Mountz products

BMX (Bench Mounted Sensor)

LB250F

Reaction Position

- Horizontally: 4" to 28" from the center of the turn-table

- Vertically: 1" to 4" from the turn-table base

Full rotation: Ratio (1:360)

Bench top Mounting holes (see fig A on page 3)

Weight of the LB250F is 53 lbs.

LB750F

Reaction Position

- Horizontally: 4.87" to 41.25" from the center of the turn-table

- Vertically: 1.87" to 5.4" from the turn-table base

Ratio (1:663)

Bench top Mounting holes (see fig A on page 4)

Weight of the LB750F is 130 lbs.

LB2000F

Reaction Position

- Horizontally: 4.87" to 75.5" from the center of the turn-table

- Vertically: 1.87" to 5.4" from the turn-table base

Ratio (1:663)

Bench top Mounting holes (see fig A on page 5)

Weight of the LB2000F is 160 lbs.

Mounting LB250F

We recommend fastening the loader on a bench top before operating. Use 3/8" bolts (the bolt length will depend on your bench top thickness). The LB250 is simple to use. Place the tool that you want to calibrate on the transducer connected to the LB250 (see figure C) and simply turn the hand wheel.

Fig. A

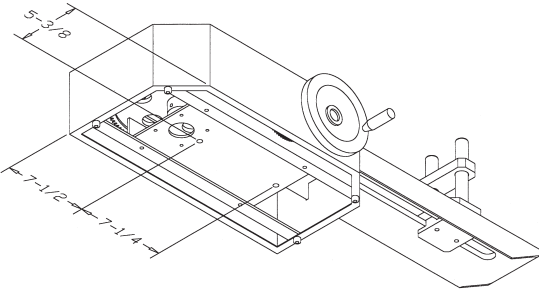

Fig. B

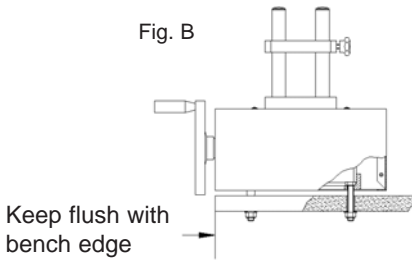
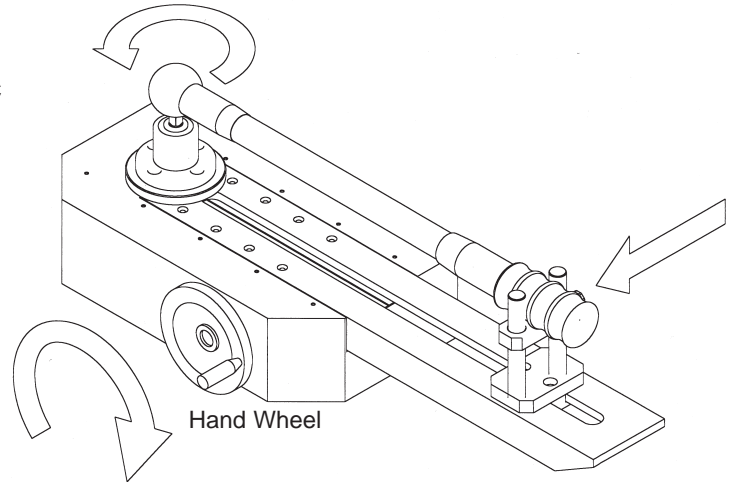
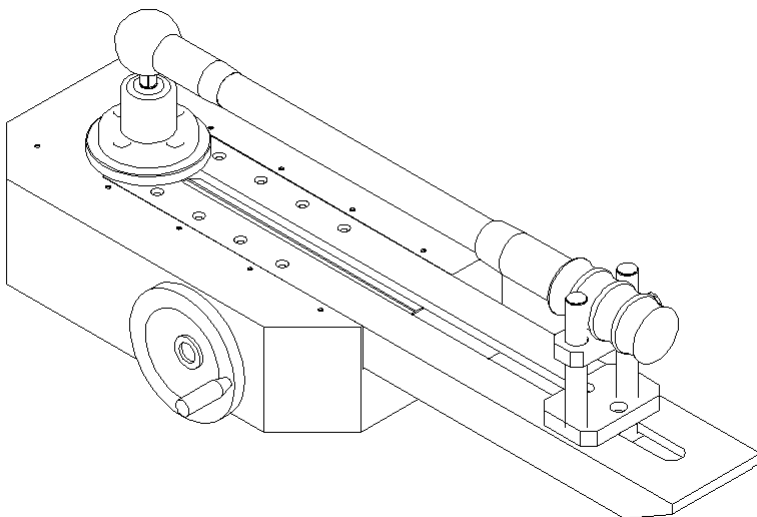

Fig. C



Application

Fig. C



This is a typical torque wrench calibration application.

Note: custom accessories for special applications can be made upon request. We strongly recommend not to modify the unit yourself.

Mounting LB750F

We recommend fastening the loader on a bench top before operating. Use 5/16" or M8 bolts (the bolt length will depend on your bench top thickness). The LB750 is simple to use. Place the tool that you want to calibrate on the transducer connected to the LB750 (see figure C) and simply turn the hand wheel.

Fig. A

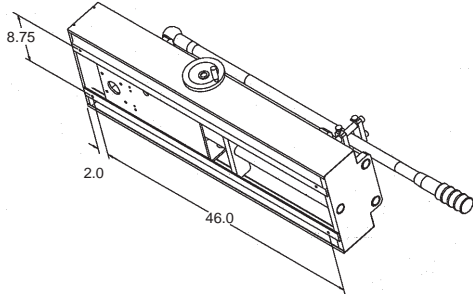

Fig. B

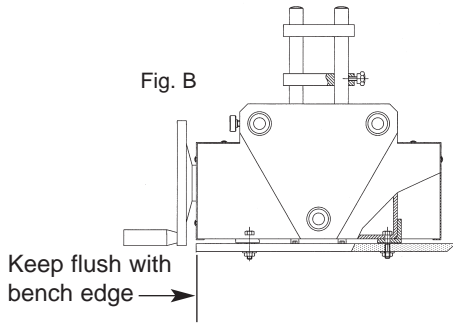
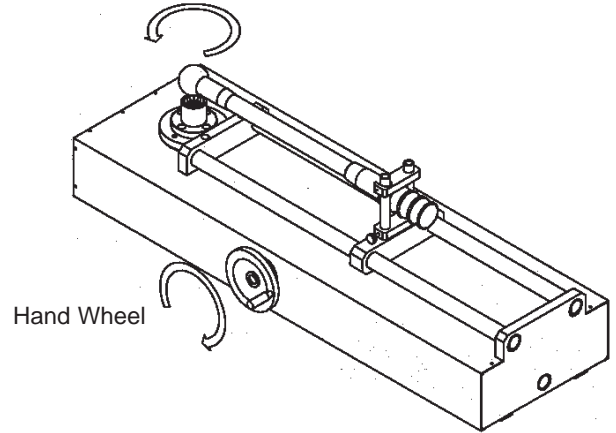
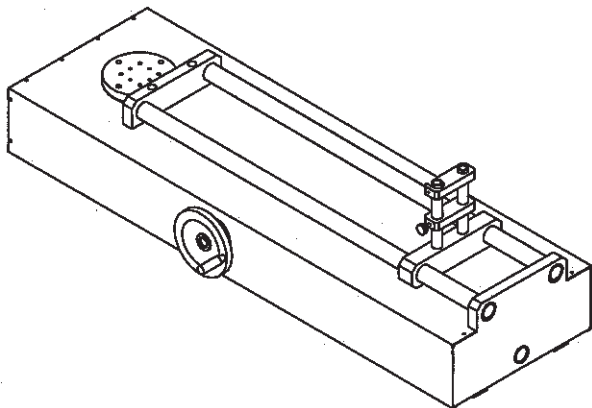

Fig. C



Application



This is a typical torque wrench calibration application.

Note: custom accessories for special applications can be made upon request. We strongly recommend not to modify the unit yourself.

Mounting LB2000F

We recommend fastening the loader on a bench top before operating. Use 5/16" or M8 bolts (the bolt length will depend on your bench top thickness). The LB2000 is simple to use. Place the tool that you want to calibrate on the transducer connected to the LB2000 (see figure C) and simply turn the hand wheel.

Fig. A

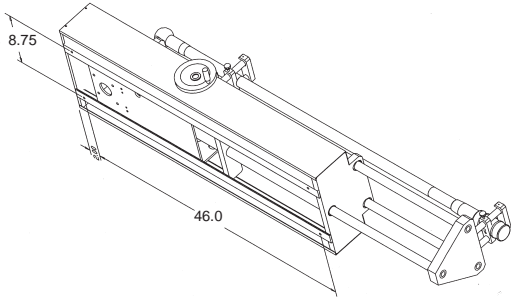

Fig. B

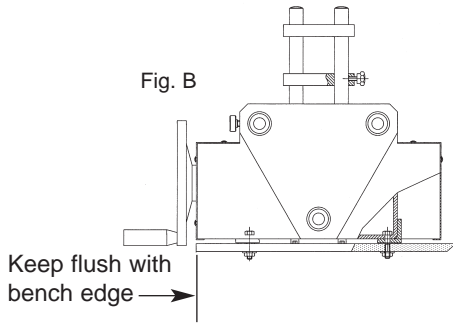
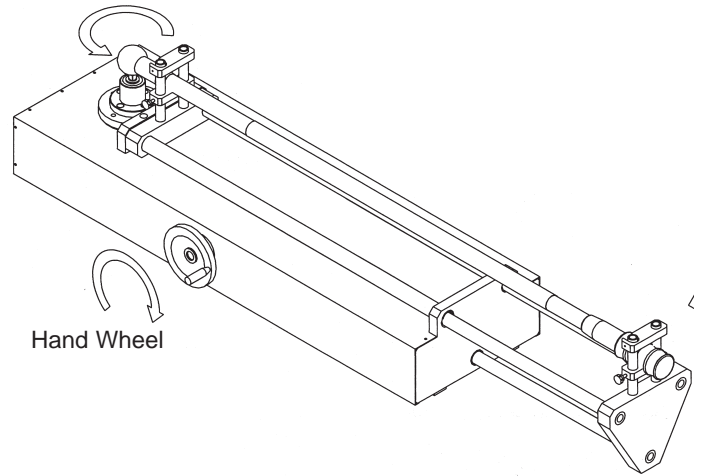
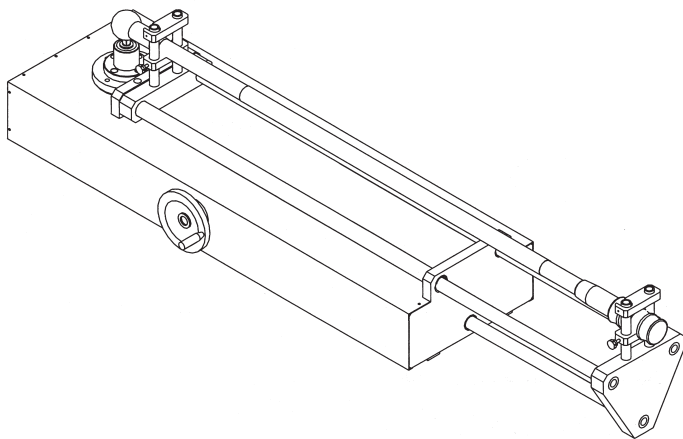

Fig. C



Application



This is a typical torque wrench calibration application.

Note: custom accessories for special applications can be made upon request. We strongly recommend not to modify the unit yourself.



Loading Bench Operation Instructions

Rev 3.0 (5/12/2011)

Mountz Calibration & Repair Services

Mountz Inc. features an experienced calibration and repair staff. Our trained technicians can calibrate and repair most any tool. Mountz provides rapid service with quality that you can trust as we offer three state-of-the-art calibration lab and repair facilities that can calibrate up to 20,000 lbf.ft.

With over 45 years of experience, Mountz's in-depth knowledge of torque is reflected in our tool's craftsmanship and our ability to provide solutions to both common and uncommon torque applications. We perform calibrations in accordance with ANSI/NCSL-Z540. Mountz is dedicated solely to the manufacturing, marketing and servicing of high quality torque tools.

Mountz is an ISO 9001 certified and ISO 17025 accredited company.

Tool Service & Repair Capability

- Torque Wrench Calibration: Click Wrench, Dial Torque Wrench, Beam Wrench, Cam-Over & Break-Over Wrench
- Torque Screwdrivers: Dial, Micrometer, Preset & Adjustable
- Torque Analyzers/Sensors: All brands
- Electric Screwdrivers: All brands
- Air Tools: All brands
Impact Wrenches, Drills, Pulse Tools, Grinders, Percussive Tools, Air Screwdrivers, Nutrunners, DC Controlled Nutrunners
- Torque Multipliers: All brands

Mountz Service Locations

Eastern Service Center

19051 Underwood Rd.
Foley, AL 36535
Phone: (251) 943-4125
Fax: (251) 943-4979

Western Service Center

1080 N.11th Street
San Jose, CA 95112
Phone: (408) 292-2214
Fax: (408) 292-2733

Mexico Service Center

Mountz Mexico SA de CV Chihuahua
Av. Cristobal Colon #15343
Col. Paseos de Chihuahua
Chihuahua, Chih. Mexico CP 31125
Phone: (614) 481-0023
Fax: (614) 481-0053

www.mountztorque.com
sales@mountztorque.com

Download a "Service Form" and include a copy when you send the tools in to be serviced.

Looking for fasteners?
www.mrmetric.com

