

MTP 10 Dial Analyzer

Version 1.0 (9/7/07)

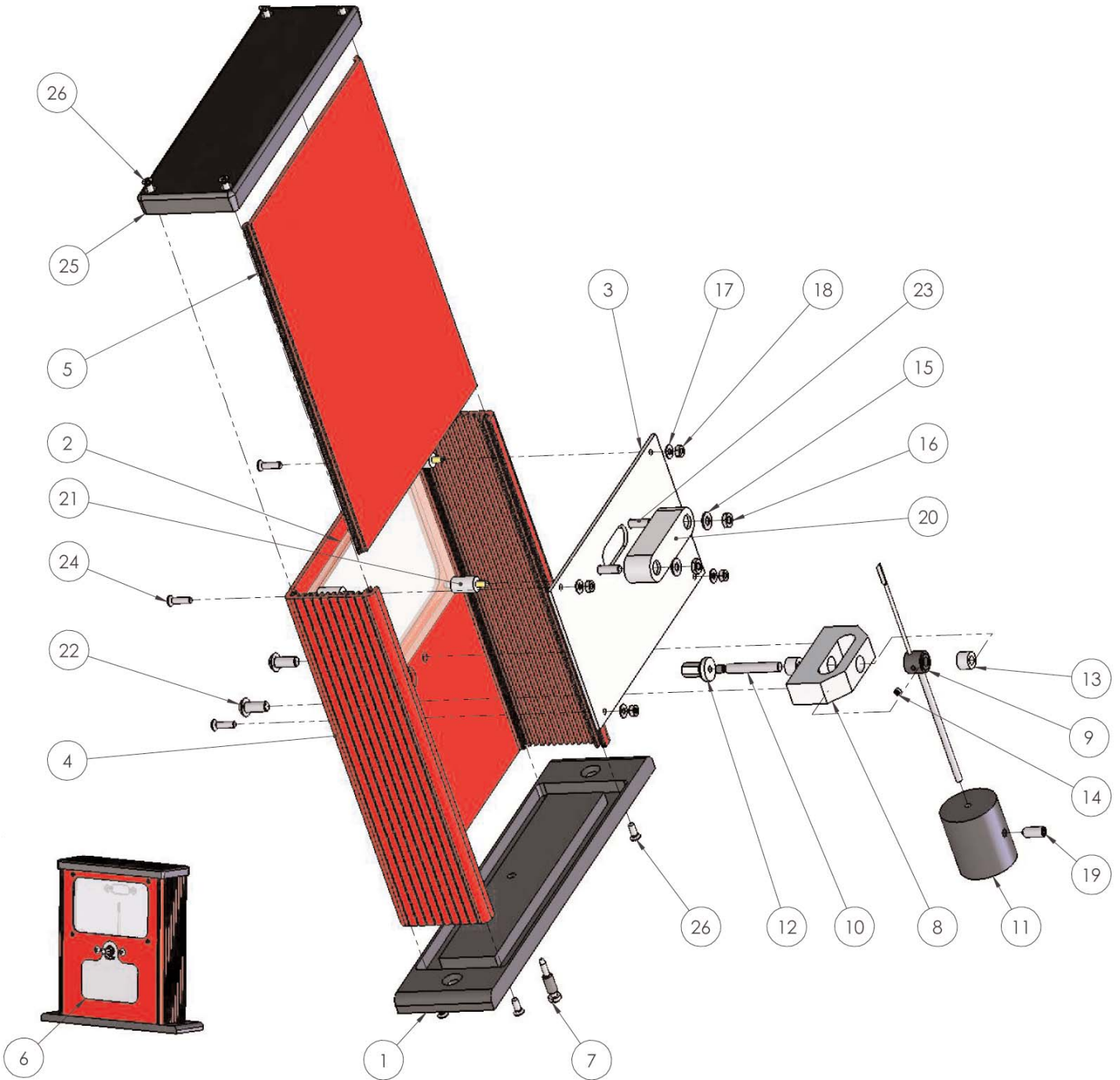



MTP 10 Dial Analyzer

No.	Part Number	Description	Qty.
1.	20-B27730	Base Plate	1
2.	20-B27740	Window	1
3.	20-B27750	Dial	1
4.	20-B27860	Box - Machining Details	1
5.	20-B27870	Back Plate - Machining Details	1
6.	20-A27430	Label	1
7.	20-A27760	Transport Screw	1
8.	20-A27790	Bearing Housing	1
9.	20-A27770	Pointer Assembly	1
	20-A27800	Collar	1
	20-A27810	Weight Arm	1
	20-A19740	Pointer	1
10.	20-A27780	Spindle	1
11.	20-A27820	Weight - 10 cN.m	1
12.	20-A27830	1/4 Hex Drive	1
13.	20-P11020	Bearing Torrington B34	2
14.	20-P11080	Skt Set Scr M3 x 3 Cone Pt	1
15.	20-P15910	Washer M4 Form A Plated	2
16.	20-P17270	Hex Full Nut M4 Steel	2
17.	20-P18480	Washer M3 Form A Plated	4
18.	20-P23020	Hex Full Nut M3 Brass	4
19.	20-P23060	Skt Set Screw M5x12	1
20.	20-P30120	Spirit Level	1
21.	20-P30130	Pillar	4
22.	20-P30140	Button Head Screw M5x12SS	2
23.	20-P30150	CSK SCR M4x25 Nylon	2
24.	20-P30160	CSK SKT Scrwe M3x12 SS	4
25.	20-P30170	Lid	1
26.	-	M3 x 8 Cross Head Screws	8