

Inverted Telescoping Arms Operation Instructions

Rev 1.1 (4/26/17)



Inverted Telescoping Arms Operation Instructions

Introduction

The Telescoping arm provides the operator full flexibility on the assembly line. Crafted with lightweight durable carbon fiber the arm collapses like a telescope. The easy-to-use arm requires little space and doesn't disrupt the flow of production. Can be mounted to a workbench or wall. The carbon fiber design provides for high level of rigidity and flexibility as well as being maintenance free. Inverted Telescoping Arms features a reinforced sleeve for long durability with higher

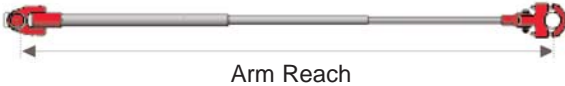

Model	Item #	Torque		Standard	Arm
		lbft.ft	N.m	Reach	Reach
EZ-70IT/1500	260175	51.6	70	26.2"	59"
EZ-70IT/2000	260176	51.6	70	32.8"	78.7"
EZ-70IT/2500	260177	51.6	70	39.4"	98.4"
EZ-120IT/1500	260178	88.5	120	27.2"	59"
EZ-120IT/2000	260179	88.5	120	33.7"	78.7"
EZ-120IT/2500	260180	88.5	120	40.3"	98.4"
EZ-200IT/1500	260181	147.5	200	36.2"	59"
EZ-200IT/2000	260182	147.5	200	46.1"	78.7"
EZ-200IT/2500	260183	147.5	200	55.9"	98.4"

Inverted Telescoping Arms Operation Instructions

Installation and Maintenance Recommendations for the Telescoping Arms

1. Make sure that the carbon fiber tubes are not subject to impact when the arm is in use.
2. The telescoping arms should not be used at maximum arm reach on a permanent basis.
3. Check that there is no excessive play in the clamp/yoke link (see Fig 1).
4. To maximize the dispersion of the torque reaction, respect the following angle positioning (see Fig 2).
5. When the Telescoping Arm is installed at horizontal position, use the universal adapter delivered with the arm.

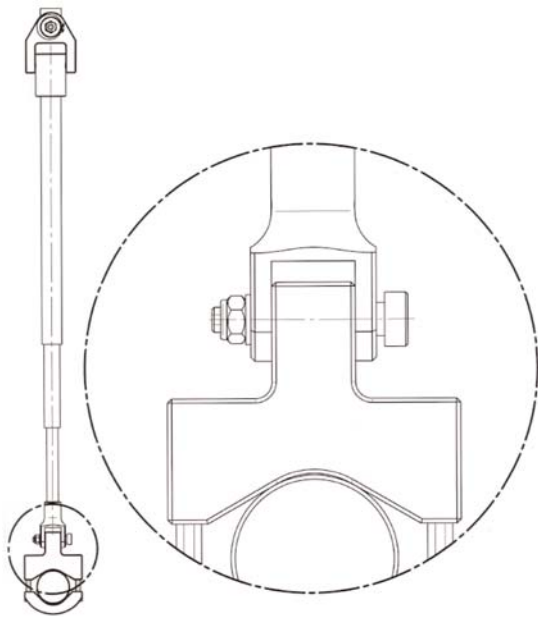

Fig 1

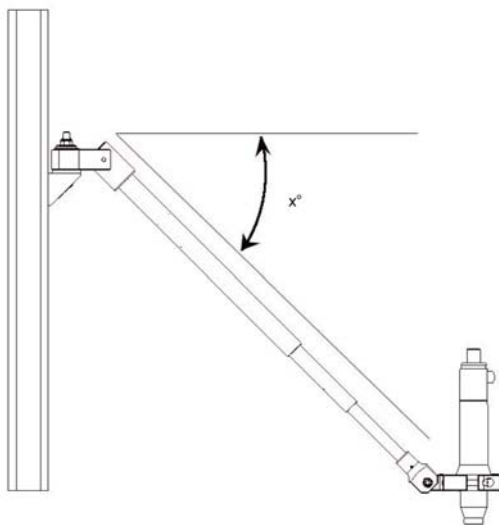

Fig 2

Angle Positioning / Torque Reaction Force

Maximum 45 degree until 30 N.m

Maximum 30 degree from 30 N.m - 100 N.m

Maximum 20 degree over 100 N.m

Inverted Telescoping Arms Operation Instructions

Vertical Position on Fix Support

The universal adapter is not necessary anymore. Remove it and mount the arm directly on the support with a fastener or bolt. Due to the built-in swivel support, the telescoping arm will remain free to move.

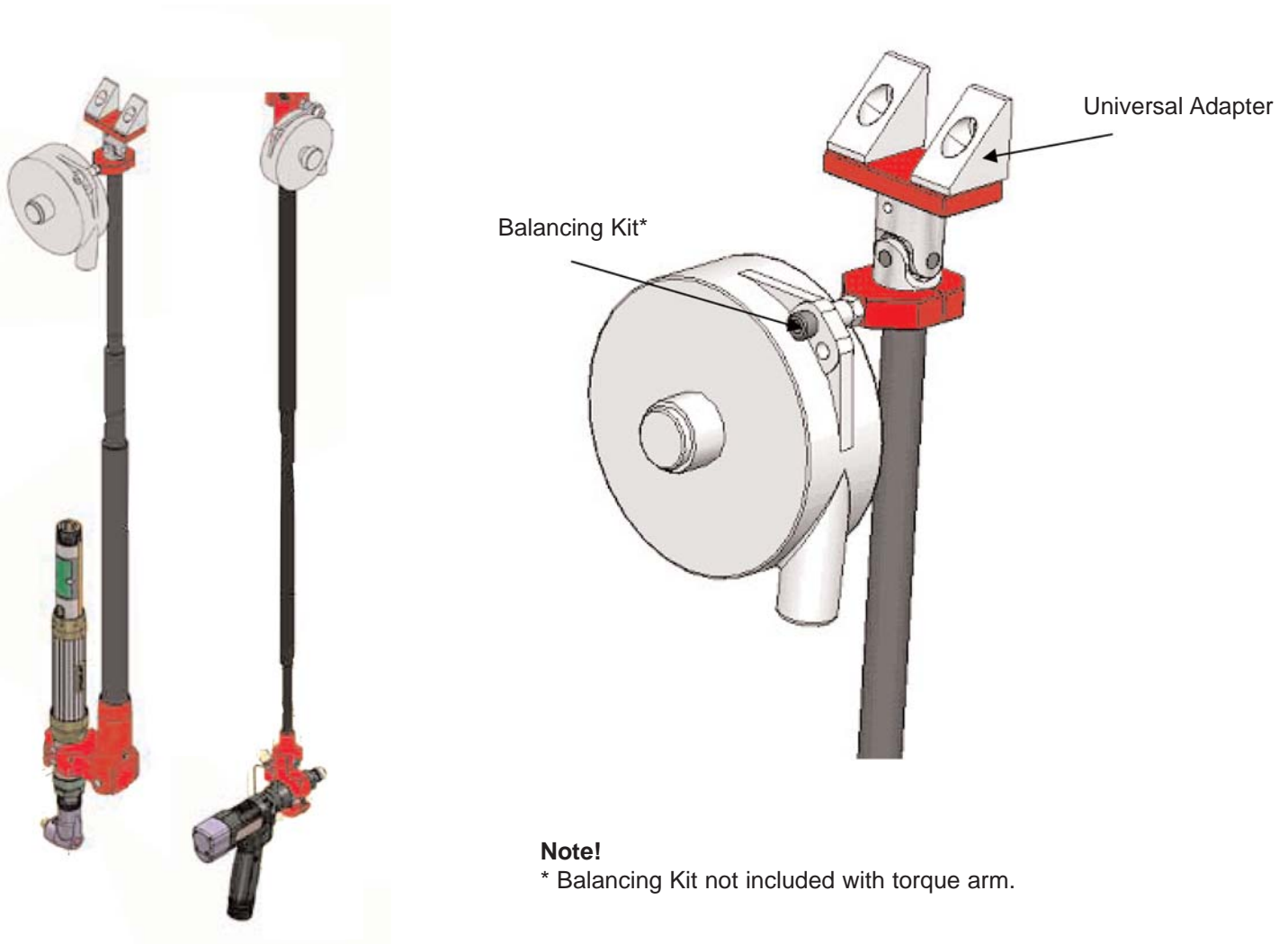

Note!

* Balancing Kit not included with torque arm.

Inverted Telescoping Arms Operation Instructions

Vertical Position on a Standard Gliding Rail System

The Telescoping Torque Arms can be mounted to the Standard Gliding Rail System (sold separately) and can be used in a variety of positions. For a vertical position it is necessary to install one additional item, an interface bracket (sold separately) along with a balancing kit (sold separately).

Standard Gliding Rail System
Each Standard Gliding Rail System includes one Carriage. Additional Carriages can purchased separately and added.
Carriage Item # 260109

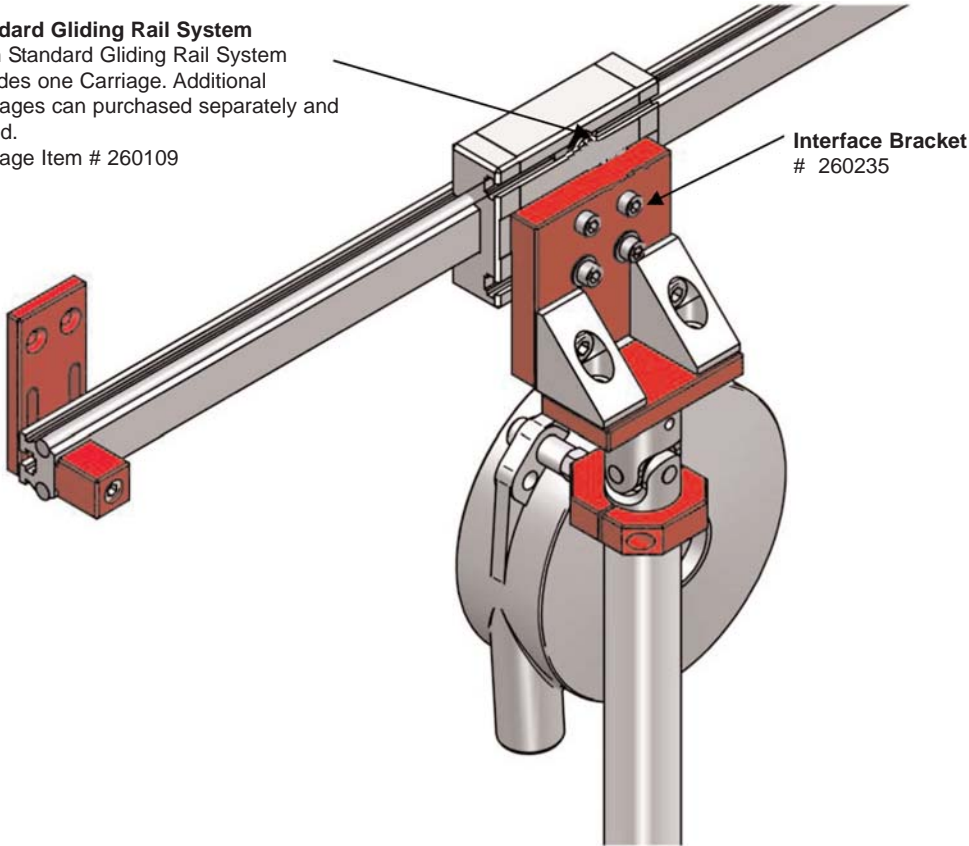

Clamp Mounting

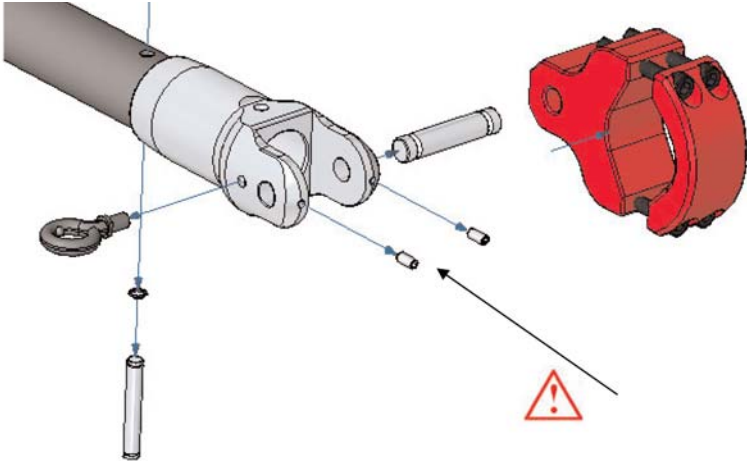

Inverted Telescoping Arms Operation Instructions

Accessory - Balancing kit

A balancing kit can be mounted on the side of any of the telescoping arms. It allows the arm to be used with pistol grip tools and angle nutrunners. **Note:** The telescoping arms should not be used at maximum arm reach on a permanent basis.

For Models	Item #	Balancer Capacity	Stroke
EZ-70IT, EZ-120IT & EZ-200IT	260190	4.4 to 8.8 lbs	78.75"
EZ-70IT, EZ-120IT & EZ-200IT	260191	8.8 to 13.2 lbs	78.75"
EZ-70IT, EZ-120IT & EZ-200IT	260192	13.2 to 17.6 lbs	78.75"

Installation of Balancer Kits with Telescoping Arms

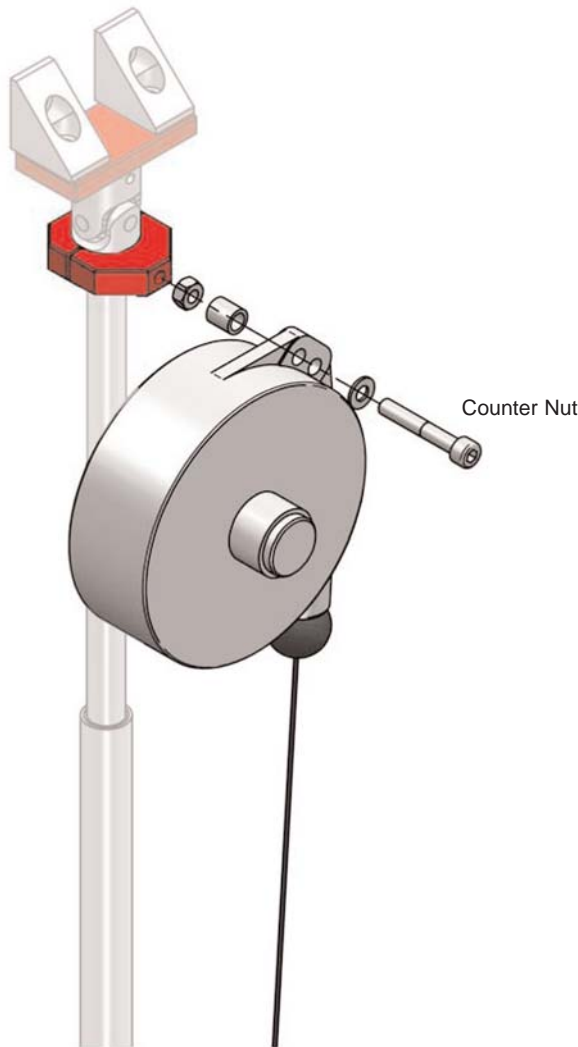

- Note:
- Make sure the balancer cable output is in line with the telescopes of the arm.
 - With the counter nut(s), make sure the balancer remains free.

Inverted Telescoping Arms Operation Instructions

Tool Positioning Options

Besides the standard in-line tool mounting position, the telescoping arm can be used with assembly tools in a variety of positions. For some tool positioning options, a different tool clamp needs to be order separately (See page 8).

Balancing Kit not included with torque arm



P2* - Standard Clamp provided with EZ-70IT, EZ-120IT & EZ-200IT

Inverted Telescoping Arms Operation Instructions

Tool Positioning Options (Continued)

Besides the standard in-line tool mounting position, the telescoping arm can be used with assembly tools in a variety of positions. For some tool positioning options, a different tool clamp needs to be order separately. **P2* - Standard Clamp provided with** EZ-70IT, EZ-120IT & EZ-200IT.

P1: Order Clamp

EZ-70IT Models #260184
 EZ-120IT & EZ-200IT Models #260187

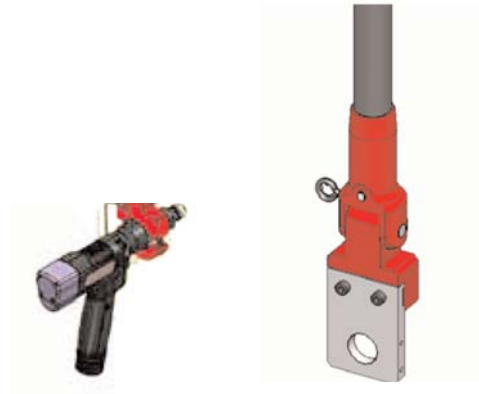

P2* - Standard Clamp provide

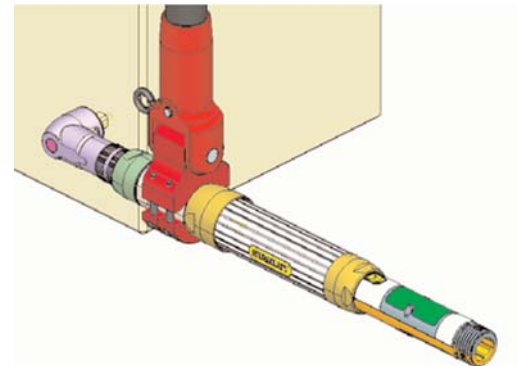

P3: Order Clamp

EZ-70IT Models #260185
 EZ-120IT Models #260188
 EZ-200IT Models **On Request

**Must provide information (Brand & Model) on each tool being used with the arm. The clamp is custom made to fit the tool being used.

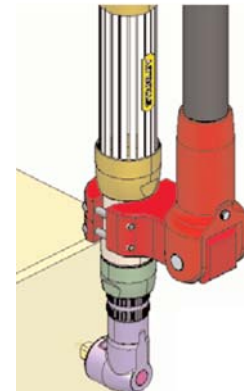

Inverted Telescoping Arms Operation Instructions

Tool Positioning Options (Continued)

Besides the standard in-line tool mounting position, the telescoping arm can be used with assembly tools in a variety of positions. For some tool positioning options, a different tool clamp needs to be order separately. **P2* - Standard Clamp provided with** EZ-70IT, EZ-120IT & EZ-200IT.

P4: Order Clamp

- EZ-70IT Models #260186
- EZ-120IT Models #260189
- EZ-200IT Models **On Request

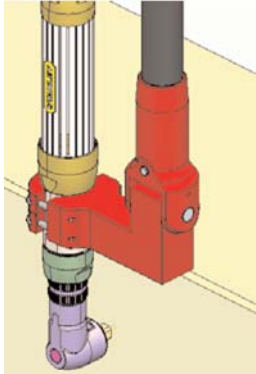

**Must provide information (Brand & Model) on each tool being used with the arm. The clamp is custom made to fit the tool being used.

N°	Quantity	Designation
1	2	Universal adapter
2	1	Mounting plate
3	1	Gimbals
4	1	Balancer holder
5	1	Carbon Rod
6**	1	Secondary tube
7	1	Primary tube
8	1	Tool Clamp holder
9	1	Tool Clamp

** Except on EZ-200IT Models

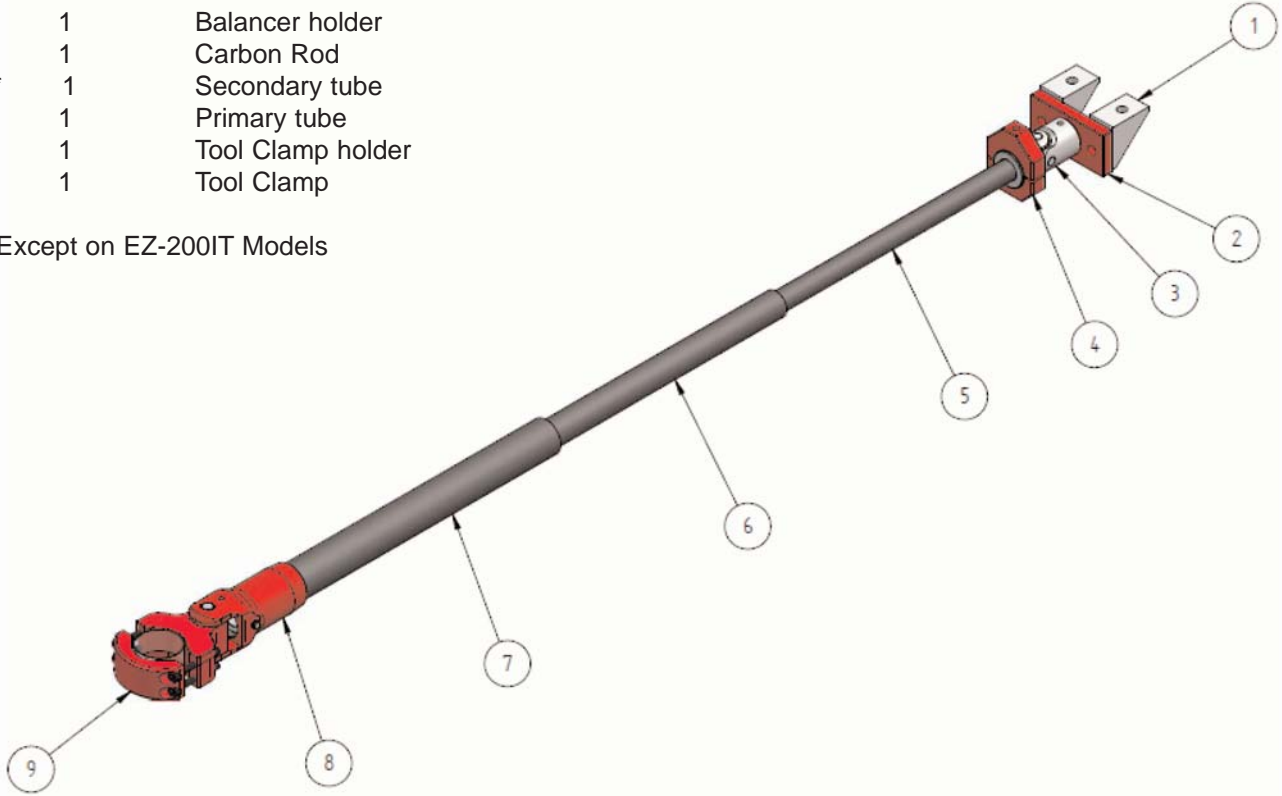

Inverted Telescoping Arms Operation Instructions

Testing Power Tools:

1. Application Method: Use a torque tester in “Peak Mode” with a rotary torque sensor between the power tool and the actual application. This is the best way to test since you are using the actual joint as the test station. You will see the actual torque applied to the fastener. **Caution:** Variances in tool performance may occur do to the addition of the rotary torque sensor.
2. Simulated Method: Always use a quality joint rate simulator (run down adapter) with a torque tester when testing power tools in a simulated application. Use Joint rate and Breakaway methods to obtain most accurate torque readings in a simulated rundown.

Mountz Calibration & Repair Services

Mountz Inc. features an experienced calibration and repair staff. Our trained technicians can calibrate and repair most any tool. Mountz provides rapid service with quality that you can trust as we offer two state-of-the-art calibration lab and repair facilities that can calibrate up to 20,000 lbf.ft.

Since 1965, Mountz’s in-depth knowledge of torque is reflected in our tool’s craftsmanship and our ability to provide solutions to both common and uncommon torque applications. We perform calibrations in accordance with ANSI/NCSL-Z540. Mountz is dedicated solely to the manufacturing, marketing and servicing of high quality torque tools.

Tool Service & Repair Capability

- Torque Wrench Calibration: Click Wrench, Dial Torque Wrench, Beam Wrench, Cam-Over & Break-Over Wrench
- Torque Screwdrivers: Dial, Micrometer, Preset & Adjustable
- Torque Analyzers/Sensors: All brands
- Electric Screwdrivers: All brands
- Air Tools: All brands
Impact Wrenches, Drills, Pulse Tools, Grinders, Percussive Tools,
Air Screwdrivers, Nutrunners, DC Controlled
Nutrunners
- Torque Multipliers: All brands

Mountz Service Locations

Eastern Service Center

19051 Underwood Rd.
Foley, AL 36535
Phone: (251) 943-4125
Fax: (251) 943-4979

Western Service Center

1080 N.11th Street
San Jose, CA 95112
Phone: (408) 292-2214
Fax: (408) 292-2733

www.mountztorque.com
sales@mountztorque.com

 **Twitter: @mountztorque**

Download a “Service Form” and include a copy when you send the tools in to be serviced.

Looking for fasteners?
www.mrmetric.com

**mr.
metric[®]**