

RG (Radial Gearing)

Pneumatic & Electric Radial Torque Multipliers

Accuracy better than $\pm 5\%$.

Compact design is safe, easy, and simple to handle.

Low profile radial head allows access where clearance is limited.

Specially designed for heat plate exchanger applications.

Continuously rotating hex drive is faster than hydraulics and more reliable than impacting tools.

Torque reaction is absorbed by means of a reaction stud.

Hex drive size reduces or enlarges with "drop in" hex adapters.

Electric models - Universal AC Input (100-253V / 45-66 Hz) and features LED display (see page 05.4).

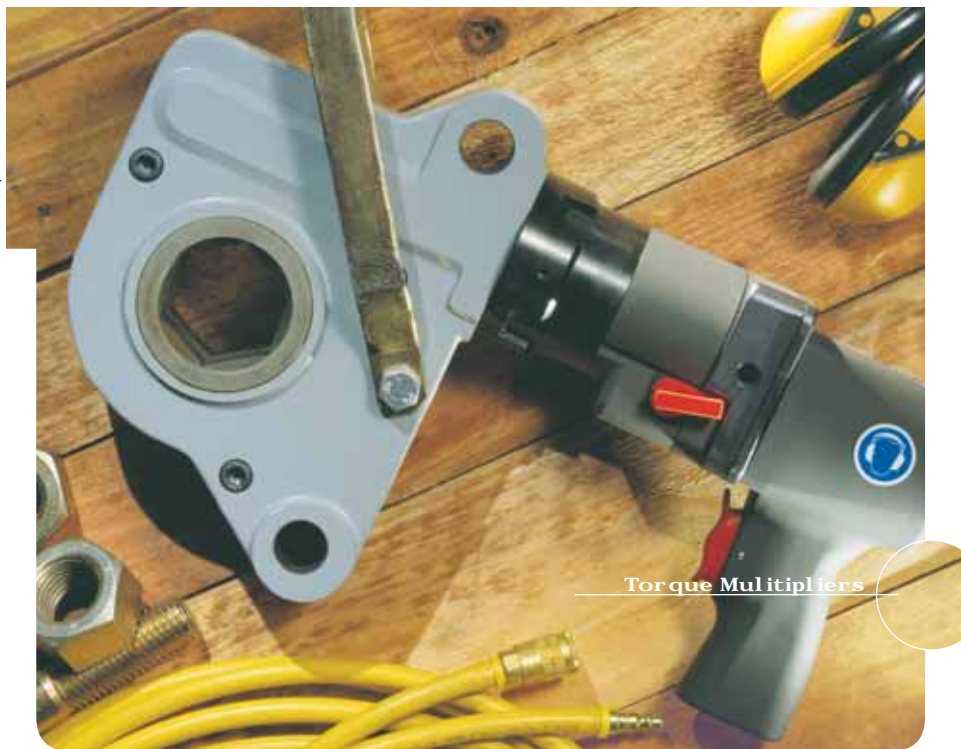

Torque Multipliers

PNEUMATIC

Model	Item #	Torque Ranges		Speed RPM	
		lbf.ft	N.m	Low	High
RCL-36P	210038	435 - 3123	590 - 4235	1	3
RCL-46P	210040	465 - 3344	630 - 4535	1	3
RCL-80P	210182	494 - 3569	670 - 4840	2	6

DIMENSIONS and WEIGHT

Model	Hex Drive mm	Length in. mm	Width in. mm	Stud Bolts A2 mm A1 mm	Radius mm	Wt. lbs.
RCL-46P	46	17.1 435	7.4 188	- 112 73	73	30.8
RCL-80P	80	17.7 450	9.1 230	160 130	85	46.3

NOTE!

All Pneumatic Multipliers should use a high quality air filter regulator.

ELECTRIC

Model	Item #	Torque Ranges		Speed RPM
		lbf.ft	N.m	
EFC-R 36P	210184	413 - 2787	560 - 3780	2
EFC-R 46P	210185	413 - 2787	560 - 3780	2
EFC-R 80P	210186	413 - 2787	560 - 3780	2
EF-R 36P	210187	413 - 2787	560 - 3780	13
EF-R 46P	210188	413 - 2787	560 - 3780	12
EF-R 80P	210189	413 - 2787	560 - 3780	11

DIMENSIONS and WEIGHT

Model	Hex Dr. mm	Length in. mm	Width in. mm	Stud Bolts A2 mm A1 mm	Radius mm	Wt. lbs.
EFC-R 46P	46	16.7 425	7.4 188	- 112 73	73	33
EFC-R 80P	80	18.7 475	9.1 230	160 130	85	48.5
EF-R 36P	36	19.6 500	6.4 163	- 100 56	56	36.3
EF-R 46P	46	21.6 550	7.4 188	- 112 73	73	41.8
EF-R 80P	80	23.6 600	9.1 230	160 130	85	57.3

RENTAL!

RG Multipliers are part of our Rental Program. Ask a customer service representative about availability.

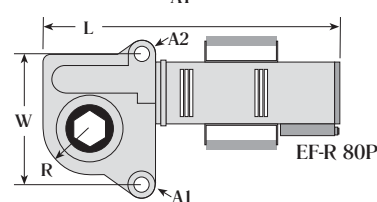
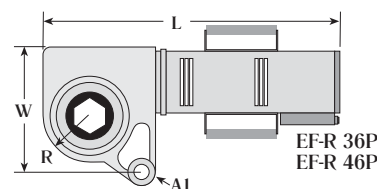
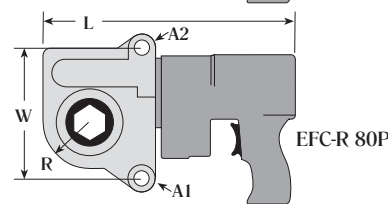
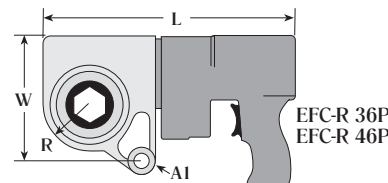
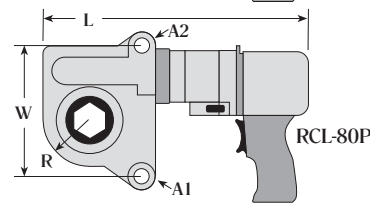
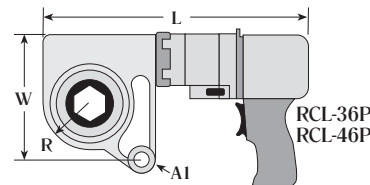

Pneumatic Model s Connect With A:

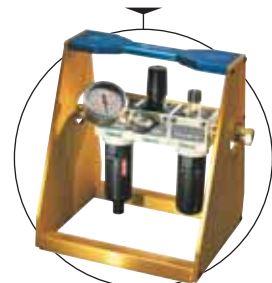

LCU-2

Provides a controlled supply of filtered, regulated and lubricated compressed air to the Multiplier.

See Page 01.13

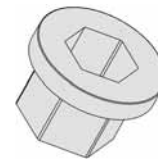

HEX ADAPTERS

Sold Separately. Stock sizes listed. Custom sizes available.

Metric Hex Drive mm			Standard Hex Drive in.		
36	46	80	36	46	80
24mm 216000	36mm 216004	46mm 216020	1 1/16"	1 7/16"	1 13/16"
27mm 216001	41mm 216005	50mm 216021	1 1/8"	1 5/8"	2"
30mm 216002		55mm 216022	1 1/4"		2 3/16"
32mm 216003		60mm 216023	3 3/32"		2 3/8"
		65mm 216024			2 9/16"
		70mm 216025			2 3/4"
					216046
					216047
					216048
					216049
					216050
					216051