

flexPower
by mountz

INSTRUCTION MANUAL

MODEL No: FLEXC-3PX
FLEXC-8PX
FLEXC-11PX
FLEXC-12PX

10.8V Cordless Shut-off Screwdriver



 **mountz**[®]
the torque tool specialists[®]

www.mountztorque.com

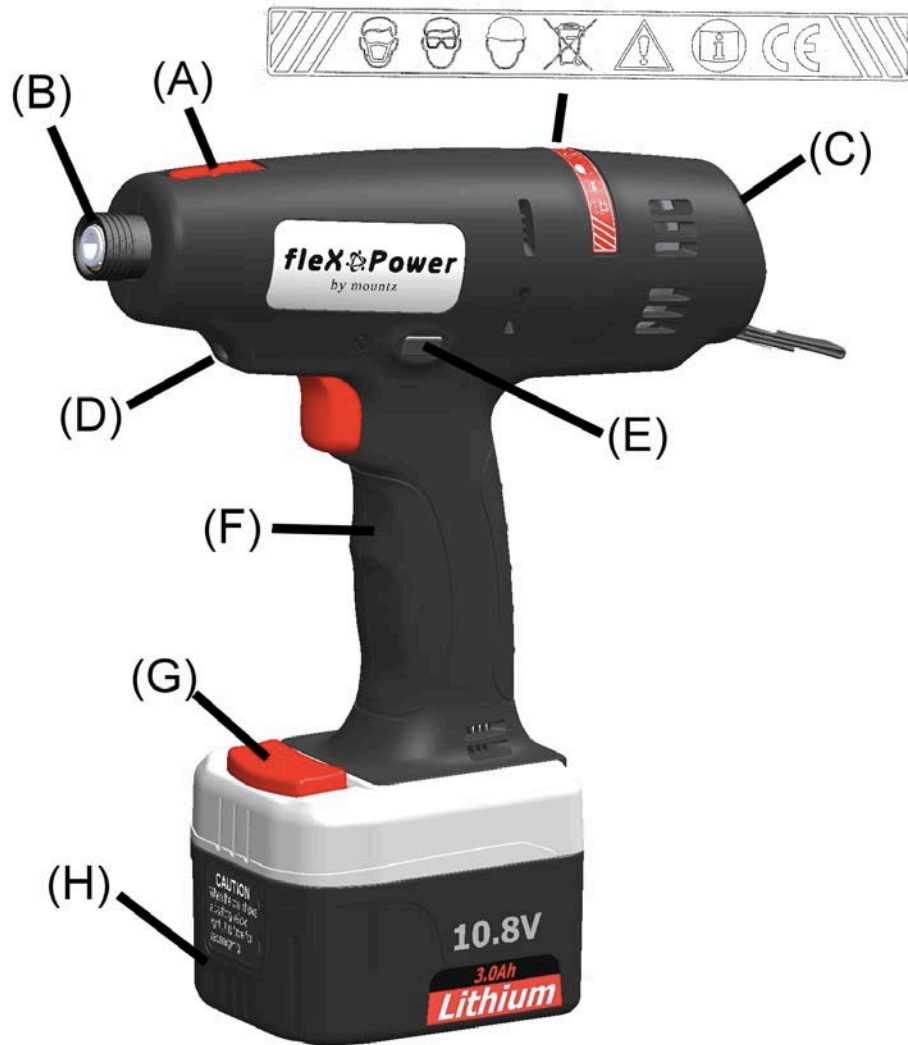

- a) Torque adjustment cover
- b) 1/4" F/Hex with quick change chuck
- c) LED indicator provides simple process information to the operator
- d) LED light for working in dark area
- e) Press button for easy Forward/Reverse operation
- f) Ergonomic handle design provides a well-balance
- g) Easy attached sliding battery system
- h) High capacity Li-ion battery pack delivers longer run-time

WARNING! "READ ALL INSTRUCTIONS" Always observe the safety regulations applicable in your country to reduce the risk of fire, electric shock and personal injury. Understand the following safety instructions before attempting to operate this product. Always wear eye protection when working with power tools. Keep these instructions in a safe place.

SAVE THESE INSTRUCTIONS

General Safety Rules

Work Area Safety

- **Keep your work area clean and well lit.** Cluttered benches and dark areas invite accidents.
- **Do not operate power tools in explosive atmospheres, such as in the presence of flammable liquids, gases, or dust.** Power tools create sparks, which may ignite the dust or fumes.
- **Keep bystanders, children, and visitors away while operating a power tool.** Distractions can cause you to lose control.

Personal Safety

- **Stay alert, watch what you are doing and use common sense when operating a power tool. Do not use tool while tired or under the influence of drugs, alcohol, or medication.** A moment of inattention while operating power tools may result in serious personal injury.
- **Dress properly. Do not wear loose clothing or jewelry. Contain long hair. Keep your hair, clothing, and gloves away from moving parts.** Loose clothes, jewelry, or long hair can be caught in moving parts.
- **Do not overreach. Keep proper footing and balance at all times.** Proper footing and balance enables better control on the tool in unexpected situations.
- **Use safety equipment. Always wear eye protection.** Dust mask, non-skid safety shoes, helmet, or hearing protection must be used for appropriate conditions.

Tool Use and Care

- **Use clamps or other practical ways to secure and support the work piece to a stable platform.** Holding the work piece by hand or against your body is unstable and may lead to loss of control.
- **Do not force tools. Use the correct tool for your application.** The correct tool will do the job better and safer at the rate for which it is designed.
- **Do not use tool if switch does not turn it on or off.** Any tool that cannot be controlled with the switch is dangerous and must be repaired.
- **Store idle tools out of reach of children and other untrained persons.** Tools are dangerous in the hands of untrained users.
- **Check for misalignment or binding of moving parts, breakage of parts, and any other condition that may affect the tool operation. If damaged, have the tool serviced before using.** Many accidents are caused by lack of maintenance or service the tools.
- **Use only accessories that are recommended by the manufacture for your model.** Accessories that may be suitable for one tool, may become hazardous when used on another tool.

INSTRUCTION MANUAL

10.8V Cordless Shut-off Screwdriver

Additional Safety Rules for Shut Off Screwdriver

Battery Charger

- Caution: To reduce risk of injury, charge only the authorized batteries. Other types of battery may burst, causing personal injury and damage.
- Before using battery charger, read all instructions and cautionary markings on batteries, chargers and products using batteries.
- Do not allow anything to cover or clog the charger vents.
- Do not expose charger to rain, snow or wet conditions.
- To reduce the risk of damage to electric plug and cord, pull by plug rather than cord when disconnecting charger.
- Use of an attachment not recommended or sold by the manufacturer may result in a risk of fire, electric shock, or injury to persons.
- Make sure cord for charger is located so that it will not be stepped on, tripped on, tripped over, or otherwise subjected to damage or stress.
- Do not abuse the power cord. Never use the cord to carry the charger. Keep cord away from heat, oil, water, sharp edges, or moving parts. Replace damaged cords immediately.
- Do not operate charger if it has been damaged in any way, take it to a qualified service center for repair.
- To reduce risk of electric shock, unplug charger from outlet before attempting any maintenance or cleaning. Turning off controls will not reduce this risk.
- Do not disassemble charger or battery cartridge, take it to a qualified service center when repair is required. Incorrect reassembly may result in a risk of electric shock or fire.

Battery Pack

- Do not charge battery pack when temperature is below 0°C (32°F) or above 40°C (104°F).
- Do not attempt to use a step-down transformer, an engine generator or DC power receptacle.
- Do not short the battery pack: Do not touch the terminals with any conductive material. Avoid storing battery cartridge in a container with other metal objects such as nails, coins, paper clips, etc.
- Do not expose battery cartridge to water or rain. A battery short can cause large current flow, overheating, possibly burns and even a breakdown.
- Do not store the machine and battery Pack in locations where the temperature may reach or exceed 50°C (122°F).
- Do not incinerate the battery pack even if it is severely damaged or completely worn out. The battery pack can explode in a fire.
- Be careful not to drop, shake, or strike the battery.
- Do not charge inside a box or container of any kind. The battery must be placed in a well ventilated area during charging.
- Do not dispose of battery packs into household waste, fire or water. Battery packs should be collected, recycled or disposed of in an environmentally friendly manner.
- **Call the authorized warranty centers for places to dispose of damaged or inoperable batteries.**

FUNCTIONAL DESCRIPTION

This industrial shut off screwdriver is designed for nut tightening/loosening and screw driving/loosening. It is not appropriate to use for wood/mild steel drilling. Please refer to the figure on the page to familiarize yourself with the major components of this tool before use.

1. **Power Switch** - Pressing the power switch will energize the LED light **(2)** in front and the tool starts to rotate. When released, power to the motor will cease and the tool stop s working immediately. The LED light will remain on for 10 seconds and then off. A small amount of sparks may appear next to the motor. This is normal as energy is being converted to heat for dissipation.
2. **Lamps** - It turns on every time that the trigger is pressed, and helps to illuminate the darks areas.
3. **Rotation Direction Switch** - Pushing this switch to the left will cause the chuck to spin in a "forward" direction, and "reverse" when pushed to the right.
4. **Quick Change Holder** - This driver accepts only 1/4"(6.35mm) hexagonal bits. Be sure the bit is fully engaged by the chuck before operating tool. Otherwise, the bit may fly off and cause property damage or personal injury.
5. **Lanyard** - The lanyard is provided to hang on the tool when not using it. Or, the lanyard can go with the belt that would provide more convenience when carrying the tool on one person. Also, it would prevent the tool from being dropped.
6. **Li-ion Battery** - This battery provides electrical power to the motor. Please charge it according to the charging instruction listed in this manual.
7. **Torque Adjustment Cover** - Open the torque adjustment cap. Use the torque adjustment tool to either tighten or loosen the spring until the desired torque is reached. Use a torque tester to view and verify torque setting.

WARNING: Use the tool to either tighten or loosen nuts and screws ONLY in specified torque and voltage ranges.



Figure 1

INSTRUCTION MANUAL

10.8V Cordless Shut-off Screwdriver

ASSEMBLY

Check for damage to the tool; parts or accessories that may have occurred during shipping . Take the time to thoroughly read and understand this manual prior to operation.

This tool contains:

- 1 10.8V cordless shut off Screwdriver
- 1 instruction manual
- 1 torque adjusting tool
- 1 Battery 10.4v and Charger 100-240 volts (sold separately)

Attaching or Removing Battery Pack

1. To connect battery, line up the tracks and attach the battery pack. Slide toward the battery pack until it locks into positions with a click.

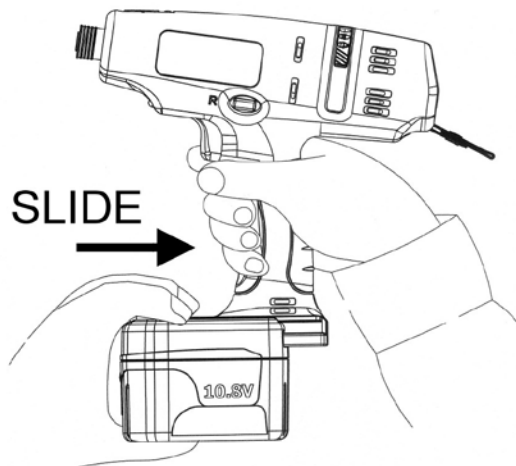

2. To remove the battery pack, push on the RED button on the top and release the battery pack.

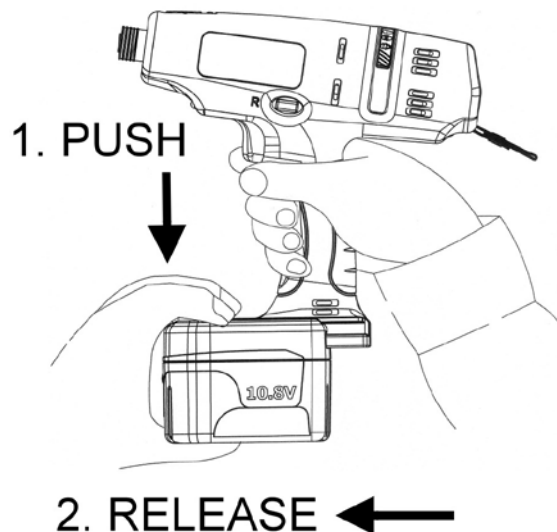

OPERATIONS

This product had been carefully inspected prior to leaving the factory. It should provide you with years of satisfying service under normal operating conditions. Do not, however, force the tool to perform outside its designed parameters. Such usage will: void the warranty.

WARNING! Read the manual instruction before operating the tool. Always wear safety glasses or face shields when operating this product. Failure to do so can result in dust, shavings or loose particles being thrown into your eyes.

1. Slide battery into the bottom of the housing handle until a click sound occurs. Do not force battery, as it should slide easily into place with nominal force. Any difficulty doing so would indicate an incorrect alignment.
2. Select a proper size drill/drive bit and insert into the quick-change holder.
3. Press the trigger to start operating the tool and the LED light will illuminate. Check the torque setting on a torque tester to see if the desired torque reached. If not, adjust the torque setting. See the steps for adjusting the torque setting on page 8.
4. Verify the torque requirements for the application before the assembly process. The torque output from the driver can change depending on various fastening factors like friction, type of joint, and the type material being used like a washer. When the torque setting is achieved, the tool will automatically shut off.

Forward/ Reverse Rotation Switch Operation

To prevent damage, do not press Forward/ Reverse button until the anvil comes a complete stop.

Forward Rotation Operation

Push the button for forward rotation. After use, set the lever to its center position.

Reverse Rotation Operation





Push the button for reverse rotation. Check the direction of rotation before use. After use, set the button to its center position.

LED Indicator

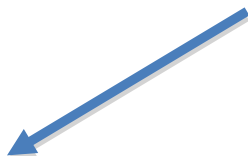

LED's



-  A green light shows the operator that the preset torque is reached and the tightening is OK.
-  A red light and one long "beep" sound signals the operator that the preset torque is not reached. The fastener must be tightened again.
-  A flashing yellow light and five short "beep" sounds give an early warning when it is time for recharging.
-  A yellow light and one long "beep" sound means a battery lock , which indicates the battery pack must be changed immediately.

Steps for Adjusting the Torque Setting

1. Lift the torque adjustment cover. Take the torque-adjusting tool and insert it to the quick-change holder and turn until the adjusting hole appears.

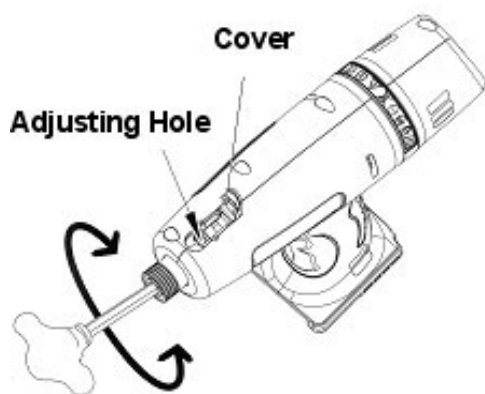

2. Use the torque-adjusting tool to turn clockwise to increase torque and turn counterclockwise to decrease torque.

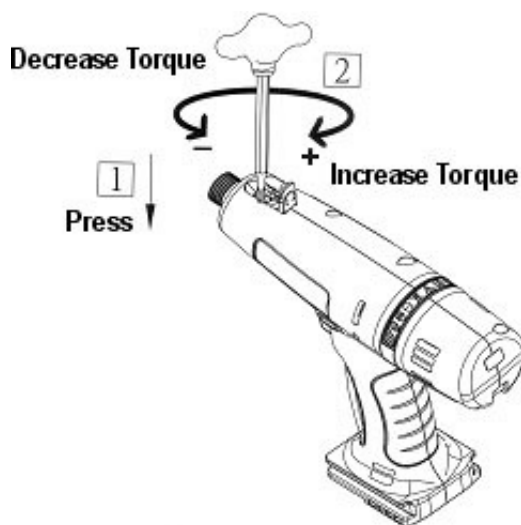

INSTRUCTION MANUAL

10.8V Cordless Shut-off Screwdriver









Charging the battery - for Li-ion battery [NOTE]





- When charging a cool battery pack (below 0°C(32°F) in a warm place, leave the battery pack at the place and wait for more than one hour to warm up the battery to the level of the ambient temperature. Otherwise battery pack may not be fully charged.
- Cool down the charger when charging more than two battery packs consecutively.
- Do not insert your fingers/ nails into contact hole, when holding charger or any other occasions.
 1. Do not place the Battery Charger in warm areas, and it requires a well-ventilated area.
 2. Plug charger into the AC outlet.
CAUTION: Ensure that the power source to be utilized conforms to the power requirement specified on the product nameplate.
 3. Turn the battery up side down and slide the battery into charger while keeping the alignment marks line up. Slide the forward in the direction of the arrow. Do not force battery, as it should slide easily into place with nominal force. Any difficulty doing so would indicate an incorrect alignment.



4. If the power lamp (red) does not light-up immediately or goes out soon after the charger is plugged in, consult an authorized service center.
5. During charging, the charging lamp (green) will start flashing. When charging is completed, an internal electronic switch will automatically be triggered to prevent overcharging. Charging will not start if the battery pack is warm. For example, immediately after heavy-duty operation. The yellow standby lamp will be flashing until the battery cools down.
6. If the temperature of the battery pack is 0°C or less, charging takes longer to fully charge the battery pack than the standard charging time. Even when the battery is fully charged, it will have approximately 50% of the power of a fully charged battery at normal operation temperature.
7. Once the battery is fully charged, the green lamp will be lit to indicate that it is in a trickle charge mode.
8. **Li-ion Battery Pack [NOTE]** Your battery pack is not fully charged at the time of purchase. Be sure to charge the battery before first use.

CHARGER LAMP INDICATIONS

		Red Light Charger is plugged into the AC outlet. Ready to charge
		Yellow Flashing 1) When the temperature of the battery is too low ($<0^{\circ}\text{C}$ / $<32^{\circ}\text{F}$), it is in a trickle charge mode until the temperature of the battery is over (0°C / $<32^{\circ}\text{F}$). The lamp will change from the Yellow Flashing to Green Flashing automatically and start to charge. (If after 70 minutes, the lamp changes from yellow flashing to yellow lit, consult an authorized dealer.) 2) When the temperature of the battery is too high ($>40^{\circ}\text{C}$ / 104°F), it is in a trickle charge mode until the temperature of the battery drops under (40°C / 104°F). The lamp will change from the Yellow Flashing to Green Flashing automatically and start to charge. (If after 70 minutes, the lamp changes from yellow flashing to yellow lit, consult an authorized dealer.) 3) When the voltage of the battery is too low (below 9 voltage), it is in a trickle charge mode until the voltage of the battery reaches the standard value. The lamp will change from the Yellow Flashing to Green Flashing automatically and start to charge. (If after 20 minutes, the lamp changes from yellow flashing to yellow lit, consult an authorized dealer.)
		Yellow Light The battery and the charger are not connected. If the yellow lit still on after trying re-attach the battery, consult an authorized service center.
		Green Flashing Now start charging
		Green Flashing Battery is approximately 50% charged

		Green Flashing Battery is approximately 80% charged.
		Green stop flashing Battery is completed charged

SPECIFICATIONS

Item	FLEXC-3PX	FLEXC -8PX	FLEXC-11PX	FLEXC -12PX
Voltage	10.8 VDC	10.8 VDC	10.8 VDC	10.8 VDC
Drive Size	1/4" F/Hex	1/4" F/Hex	1/4" F/Hex	1/4" F/Hex
Bolt Capacity	M3-M4	M4-M5	M4-M6	M4-M6
Torque Ranges	8.8-26.5 lbf.in (1-3 N.m)	17.7-70.8 lbf.in (2-8 N.m)	26.5-97.3 lbf.in (3-11 N.m)	35.4-106.2 lbf.in (4-12 N.m)
RPM	1100	800	500	300
Weight w/Battery	3.3 lbs (1.5 kg)	3.3 lbs (1.5 kg)	3.3 lbs (1.5 kg)	3.3 lbs (1.5 kg)
Length	7 7/8" (200mm)	7 7/8" (200mm)	7 7/8" (200mm)	7 7/8" (200mm)
Battery Type	Li-ion 3.0 A.h.	Li-ion 3.0 A.h.	Li-ion 3.0 A.h.	Li-ion 3.0 A.h.
Charge Time	Approx. 60 minutes	Approx. 60 minutes	Approx. 60 minutes	Approx. 60 minutes

CLUTCH UNITS

For Models:

FLEXC-8PX (Index No. 15~30) FLEXC-11PX (Index No. 14~29) FLEXC-12PX (Index No. 16~31)

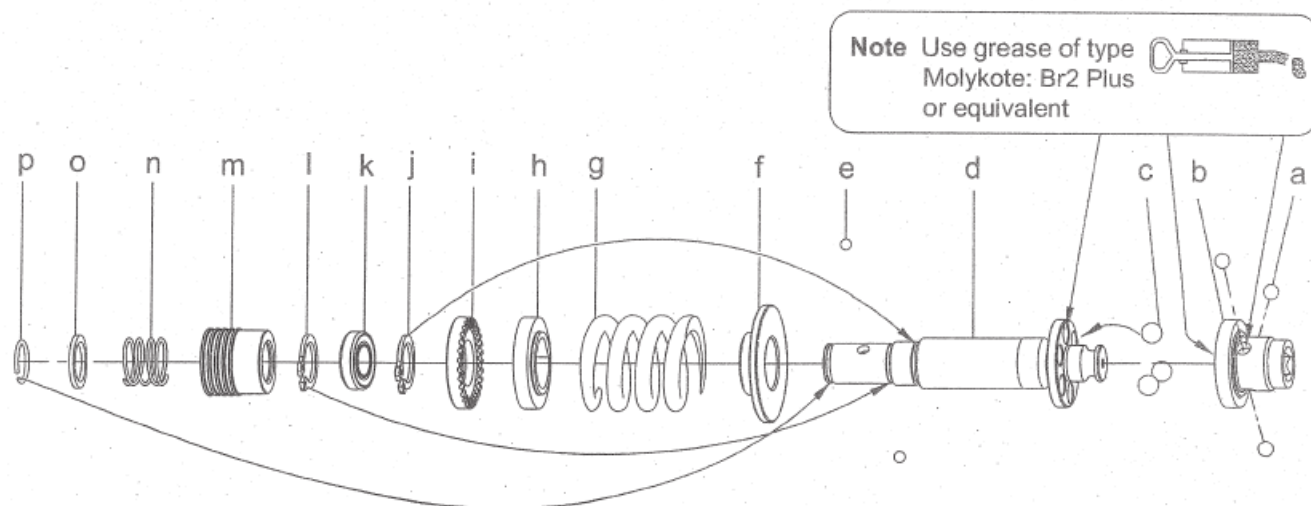

Index No	Description	Qty	Index No	Description	Qty
a	Steel Ball	3	i	Adjustment Nut	1
b	Clutch	1	j	Snap Ring	1
c	Steel Ball	3	k	Ball Bearing	1
d	Shaft	1	l	Snap Ring	1
e	Steel Ball	2	m	Quick Change Holder	1
f	Washer	1	n	Spring	1
g	Spring	1	o	Hold Spencer	1
h	Adjustment washer	1	p	Anvil Collar	1

NOTE: This chart only referenced the parts in the drawing, for ordering parts please consult the parts list per model in our website www.mountztorque.com

For Model: FLEXC-3PX (Index No. 14~29)

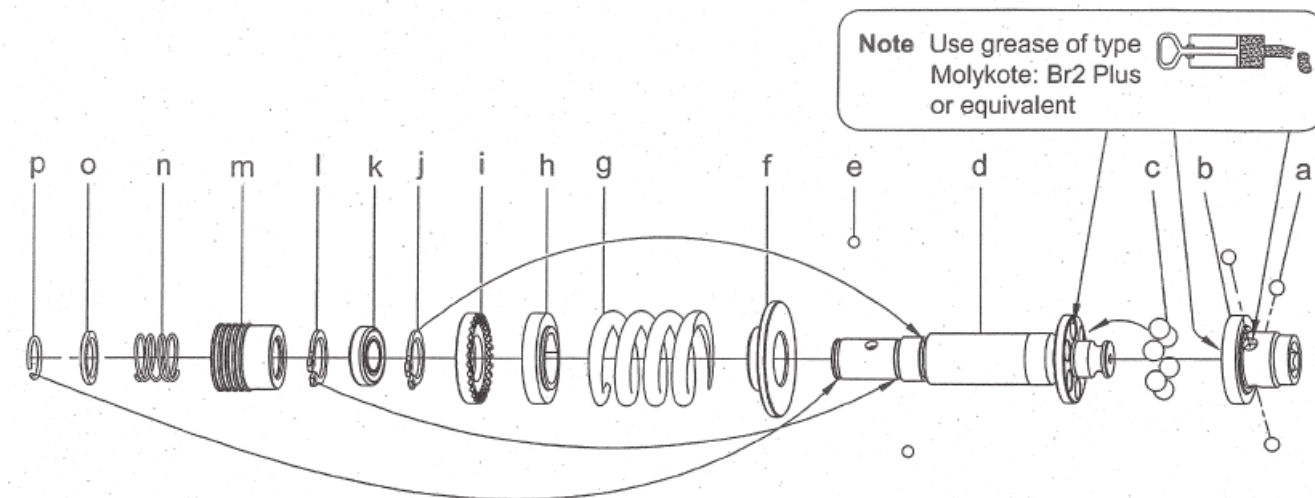

Index No	Description	Qty	Index No	Description	Qty
a	Steel Ball	3	i	Adjustment Nut	1
b	Clutch	1	j	Snap Ring	1
c	Steel Ball	6	k	Ball Bearing	1
d	Shaft	1	l	Snap Ring	1
e	Steel Ball	2	m	Quick Change Holder	1
f	Washer	1	n	Spring	1
g	Spring	1	o	Hold Spencer	1
h	Adjustment washer	1	p	Anvil Collar	1

NOTE: This chart only referenced the parts in the drawing, for ordering parts please consult the parts list per model in our website www.mountztorque.com

GEAR BOX UNITS

FLEXC-3PX (Index No. 7~12) FLEXC-11PX (Index No. 7~12)

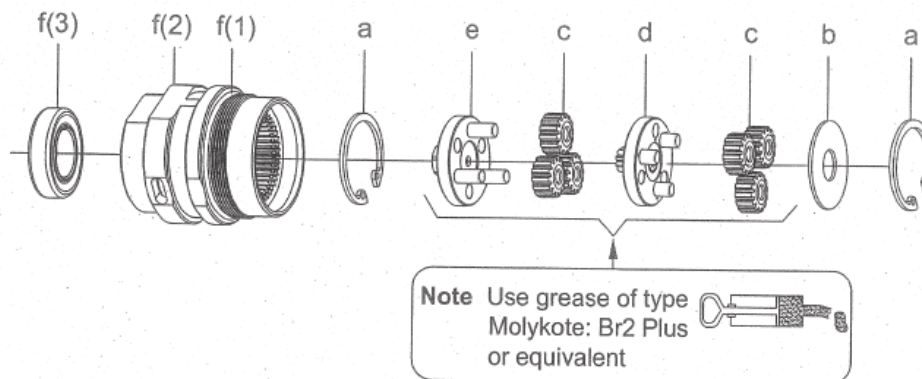

Index No	Description	Qty	Index No	Description	Qty
a	Snap Ring	1	e	Gear Plant Assembly	1
b	Washer	1	f(1)	O-ring	1
c	Plant Gear	6	f(2)	Gear Box	1
d	Gear Cage Assembly	1	f(3)	Ball Bearing	1

FLEXC-8PX (Index No. 7~13)

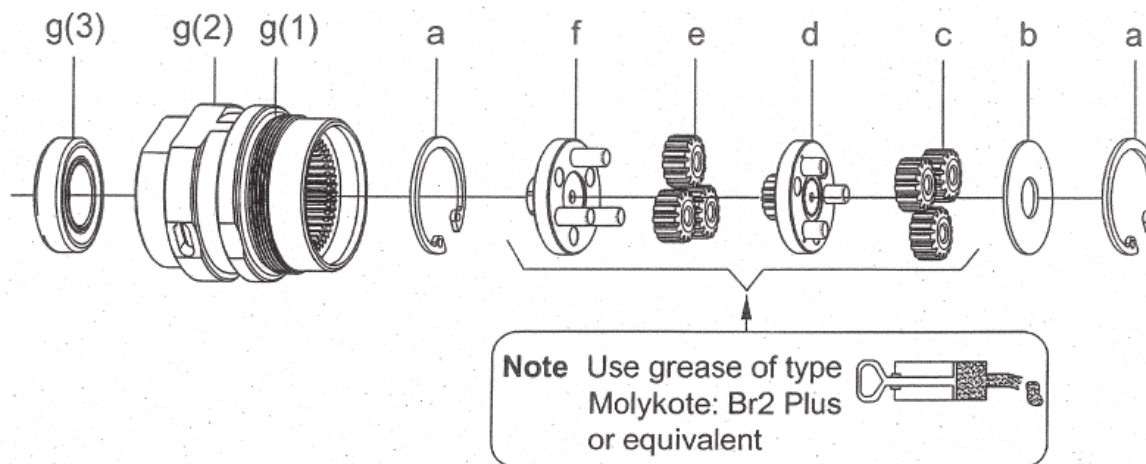

Index No	Description	Qty	Index No	Description	Qty
a	Snap Ring	1	f	Gear Plate Assembly	1
b	Washer	1	g (1)	O-ring	1
c	Plant Gear	3	g (2)	Gear Box	1
d	Gear Cage Assembly	1	g (3)	Ball Bearing	1
e	Plant Gear	3			

NOTE: These charts only referenced the parts in the drawing, for ordering parts please consult the parts list per model in our website www.mountztorque.com

GEAR BOX UNITS

FLEXC-12PX (Index No. 7~14)

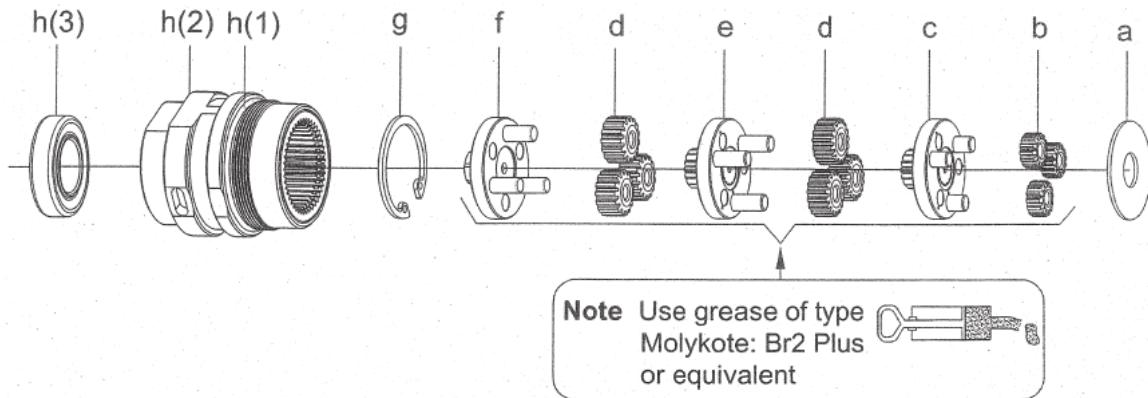

Index No	Description	Qty	Index No	Description	Qty
a	Washer	1	f	Gear Plate Assembly	1
b	Plant Gear	3	g	Snap Ring	1
c	Gear Cage Assembly	1	h (1)	O-Ring	1
d	Plant Gear	6	h (2)	Gear Box	1
e	Gear Cage Assembly	1	h (3)	Ball Bearing	1

NOTE: The chart only referenced the parts in the drawing, for ordering parts please consult the parts list per model in our website www.mountztorque.com

INSTRUCTION MANUAL

10.8V Cordless Shut-off Screwdriver

HOUSING & MOTOR

For Models: FLEXC-3PX (Index No. 1~6, 30~41) FLEXC-8PX (Index No. 1~6, 31~42)
FLEXC-11PX (Index No. 1~6, 30~41) FLEXC-12PX (Index No. 1~6, 32~43)

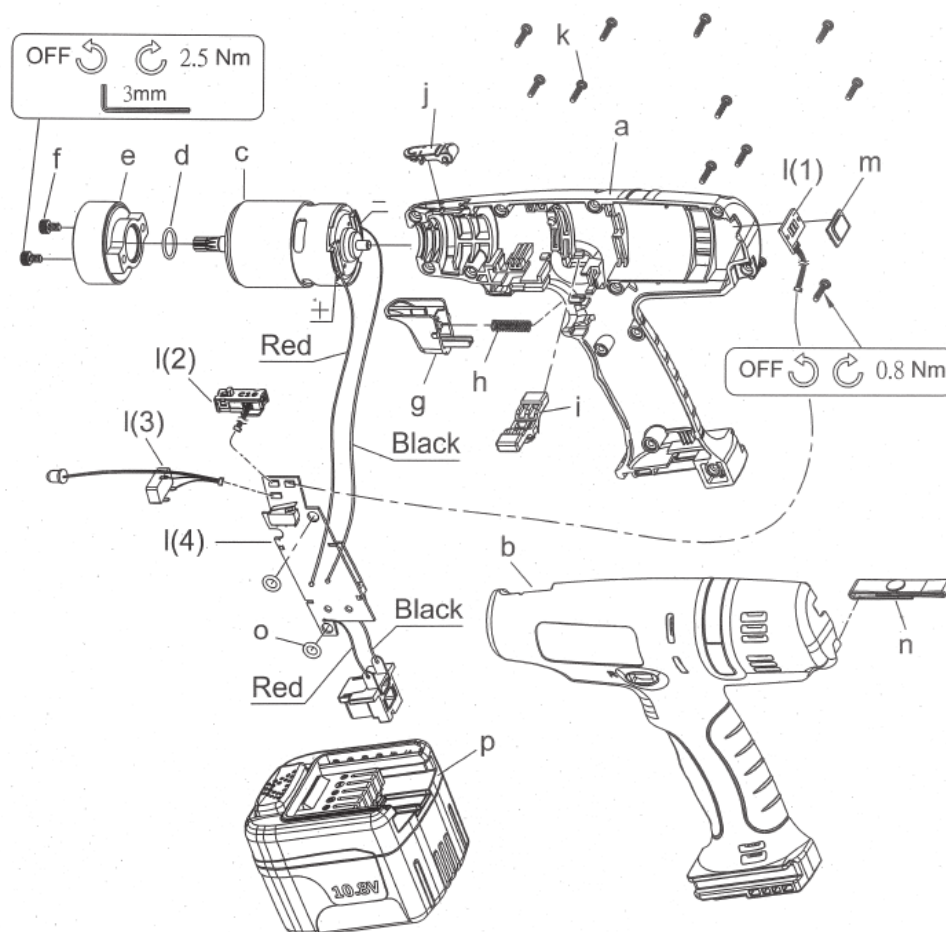

Index No	Description	Qty	Index No	Description	Qty
a	Washer	1	k	Screw	12
b	Plant Gear	1	l (1)	Indicator	1
c	Gear Cage Assembly	1	l (2)	Sensor Assembly	1
d	Plant Gear	1	l (3)	F/R Switch Assembly	1
e	Gear Cage Assembly	1	l (4)	PC Board	1
f	Screw	2	m	Indicator Cover	1
g	Trigger	1	n	Lanyard	1
h	Spring	1	o	O-Ring	2
i	F/R Valve	1	p	Li-ion 3Ah Battery Pack	1
j	Cover	1			

NOTE: The chart only referenced the parts in the drawing, for ordering parts please consult the parts list per model in our website www.mountztorque.com

Service Centers

USA

Corporate Headquarters & Service Center

1080 North 11th Street San Jose, CA 95112
Phone: (800) 456-1828 Fax: (408) 292-2733

Distribution & Service Center

19051 Underwood Road Foley, AL 36535
Phone: (251) 943-4125 Fax: (251) 943-4979

Mexico

Mountz Mexico SA de CV

Ave. Cristobal Colon #15343
Col. Paseos de Chihuahua
Chihuahua, Chih. Mexico CP 31125
Phone: (614) 481-0023 Fax: (614) 481-0053

